

## GJS-D1449

### 144 Fibers Heat-shrink Seal Dome Closure

#### Application

- Protects fiber splice points from environmental hazards (e.g., water permeation) with IP68 rating.
- Suitable for aerial, cable duct, direct-buried, wall-mounted, and pole-mounted installations.



#### Features & Benefits

- High-quality MPP engineering plastic housing with excellent mechanical strength, hydrolysis resistance, and chemical stability.
- 1 oval port (cable dia. max. data missing) and 8 circular ports ( $\phi 12$  mm max.) for flexible cable management.
- Reliable sealing system achieving IP68 protection, with heat-shrinkable sleeves for cable ports.
- 6 splice trays supporting up to 144 fibers (12/24 FO per tray) with storage for uncut cables.
- Metal kits for fixing cable sheaths and strength members, with optional grounding provisions.
- Reusable rubber grommets maintain sealing integrity through multiple installations.

## Specifications

Part No.	GJS-D1449
Dimensions (L×W×H)	445 × Ø188 mm (17.52 × 7.40 in)
Material of Enclosure	PP+GF
Base Sealing Method	Dome-to-base clamp with O-ring
Cable Sealing Type	Heat-shrink Sealing
Cable Entry Ports	1 Oval Port (65×37mm)
Cable Exit Ports	8 Round Ports (Ø12mm)
Splicing Capacity (Max)	144 Fibers (Single-core)
Number of Splice Trays (Max)	6 Trays
Material of Trays	ABS
Inflating Valve	Pre-installed (Optional)
Grounding Device	Pre-installed (Optional)
IP Rating	IP68
Mounting	Aerial / Wall Mount / Pole Mount / Direct-Buried

## Mounting Options

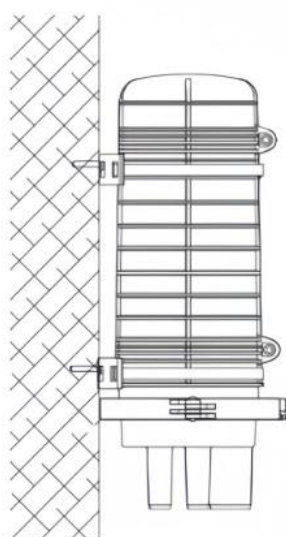

Wall mounting

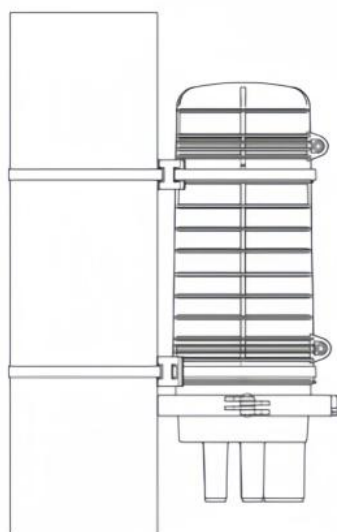

Pole mounting



Aerial hanging

## Packing List

Part No.	Carton Size	PCS/CTN	G.W.
GJS-D1449	60×48.5×48.5CM (23.6×19.1×19.1IN)	6	20KG