

FDB-A3316E-16A

3-IN 3-OUT Aerial Fiber Distribution Box

Application

- Designed for FTTH, FTTB, and FTTC projects, providing robust fiber management for splicing, splitting, and patching in aerial setups.
- IP65 Rated, weather-resistant enclosure ensures reliable performance for outdoor aerial or pole-mounted installations.



Features & Benefits

- Constructed with durable engineering plastic for enhanced impact resistance and longevity.
- IP65 Offers superior dust and water resistance, ideal for harsh outdoor environments.
- Supports up to 16 SC adapters and 16 drop cables for efficient fiber distribution.
- Features 3+3 inline ports and 16 drop cable ports for streamlined cable management.
- Equipped with two hasp locks for secure access and easy maintenance.
- Includes aerial kits for flexible installation on steel cables or poles.

Specifications

Part No.	FDB-A3316E-16A
Dimensions	290×185×108 mm
Enclosure Material	PC+ABS
Cable Entry Ports	1+1 inline ports × Ø18mm
Branches	2+2 inline ports × Ø11.5mm
Cable Exit Ports	5 ports x Ø3mm
Patching Capacity	16 SC Adapters
Splicing Capacity	24 Fibers (Single-core)
Number of Trays	1 Tray
Suitable Splitter	1×8 or 1×16 Micro PLC Splitters
Tray Material	ABS
IP Rating	IP65
Mounting	Aerial

Dimension Drawing

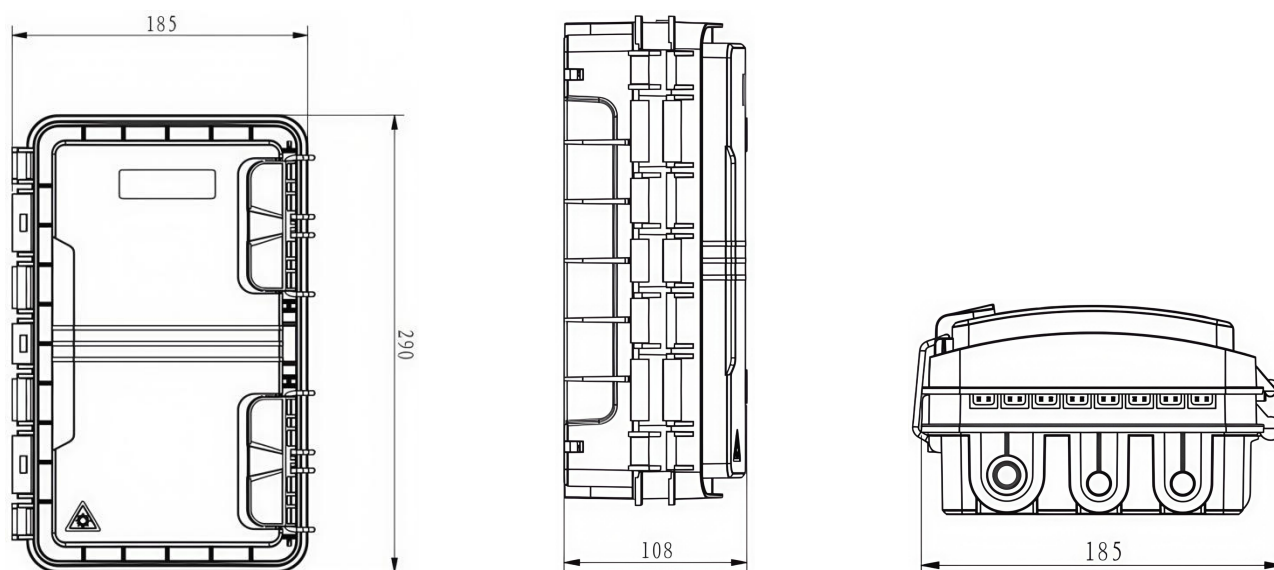

Micro PLC Splitter Position

Two for 1×8 Micro PLC Splitters

1×16 Micro PLC Splitters

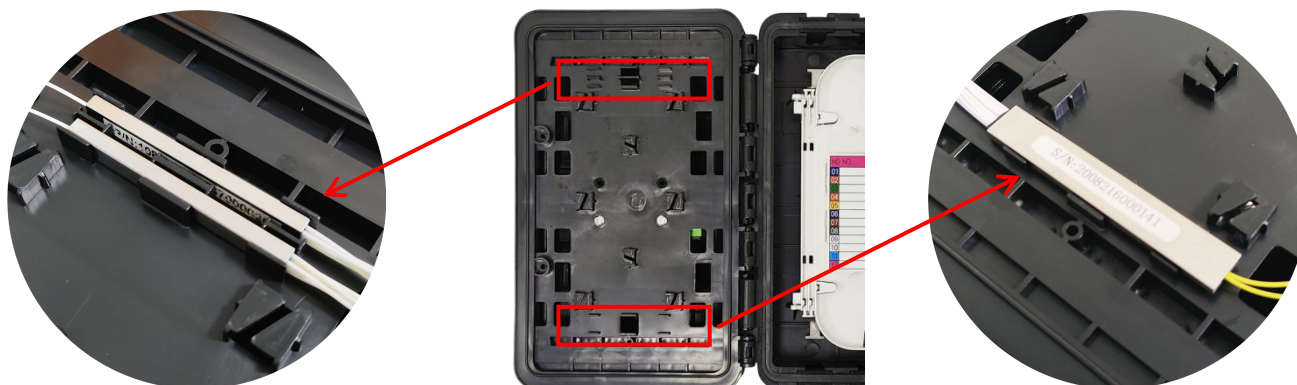

Accessories

Picture	Name	Size	Quantity
	Aerial Kit	/	2 PCS
	Nylon Cable Tie	3×100mm	10 PCS
	Splice Sleeve	1.2/45mm	16 PCS
	Buffer Tube Protection Sleeve	L=500mm	1 PC
	House Clamp	/	6 PCS

Packing List

Part No.	Carton Size	PCS/CTN	G.W.
FDB-A3316E	68×33×43CM	10	12 KG